

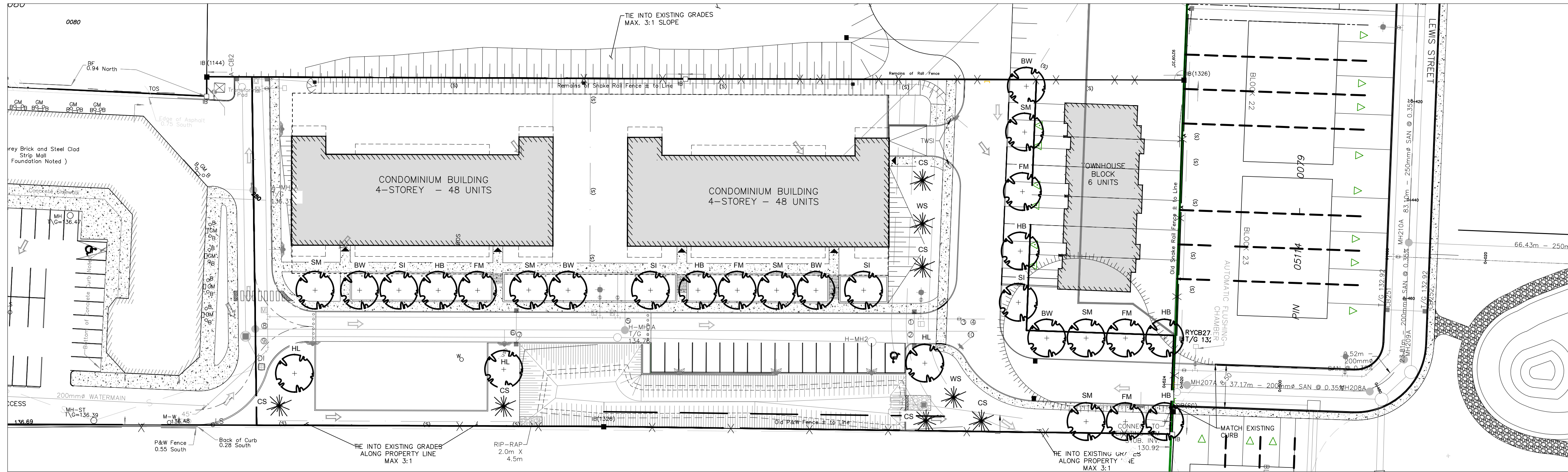

LEGEND

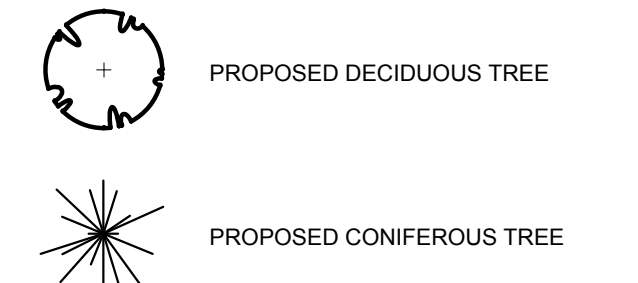

1 TREE PLANTING PLAN
L.1 SCALE 1:500

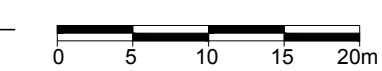

KEY	QTY.	BOTANICAL NAME	COMMON NAME	SIZE	CONDITION	REMARKS
TREES						
BW	5	<i>Tilia americana</i>	Basswood	60mm CAL.	B&B	
CS	6	<i>Picea pungens</i>	Colorado Spruce	2.0m Ht.	B&B	
FM	5	<i>Acer x freemanii</i>	Freeman's Maple	60mm CAL.	B&B	
HB	5	<i>Celtis occidentalis</i>	Hackberry	60mm CAL.	B&B	
HL	3	<i>Gleditsia triacanthos</i>	Honey Locust	60mm CAL.	B&B	
SI	4	<i>Acer saccharinum</i>	Silver Maple	60mm CAL.	B&B	
SM	6	<i>Acer saccharum</i>	Sugar Maple	60mm CAL.	B&B	
WS	2	<i>Picea glauca</i>	White Spruce	2.0m Ht.	B&B	

GENERAL NOTES:

- It is the responsibility of the appropriate contractor or official to report any errors, omissions or discrepancies on this plan with actual site conditions to the Landscape Architect before proceeding with construction.
- The contractor is to notify all utility companies and authorities prior to any excavation and ascertain locations of underground services.
- The contractor is to reinstate all areas and items damaged as a result of construction activity.
- The contractor is to comply with all pertinent codes and by-laws.
- The contractor is to maintain a positive surface run-off throughout the entire construction period.
- The Landscape Architect is not responsible for subsurface conditions.
- The contractor is to identify all existing trees to remain on site with the Landscape Architect prior to construction.
- The contractor is to stake the proposed location of all plant material in conjunction with the Landscape Architect prior to excavation.
- Minimum distances for selected trees are as follows:
 - Building Foundations 7.5m
 - Sidewalks 1.5m
 - Public Streets 2.5m
 - Underground Infrastructure 2.0m
 - Watermain 2.0m
- All trees within 1m of underground utility trenches are to be excavated by hand.
- Remove all protective wrapping from tree trunks after installation.
- Staking of trees shall only be performed if necessary.
- Ensure that mulch is pulled back a min. distance of 75mm from base of tree trunk.

2 DECIDUOUS TREE PLANTING
L.1 SCALE: NTS

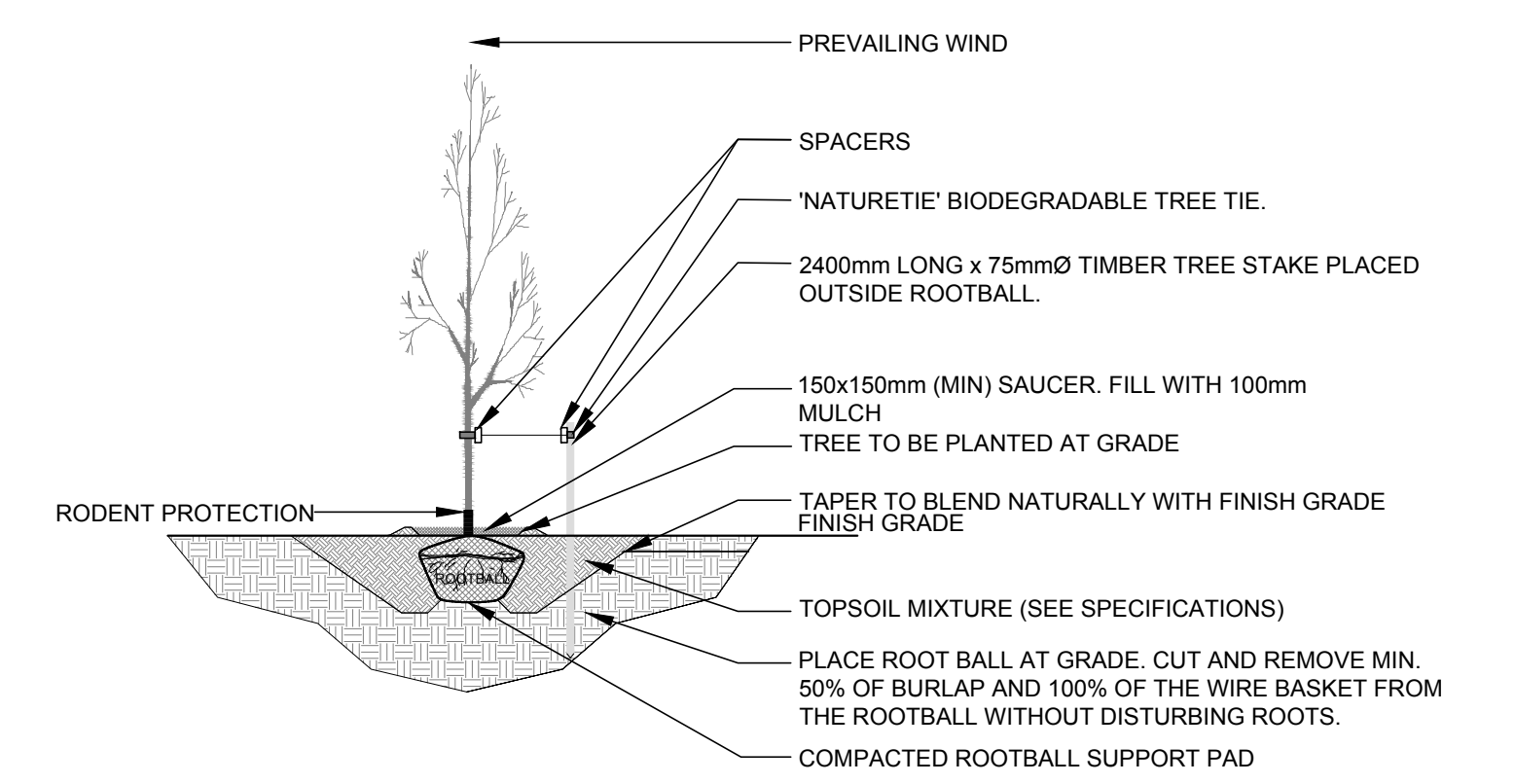

3 CONIFEROUS TREE PLANTING
L.1 SCALE: NTS

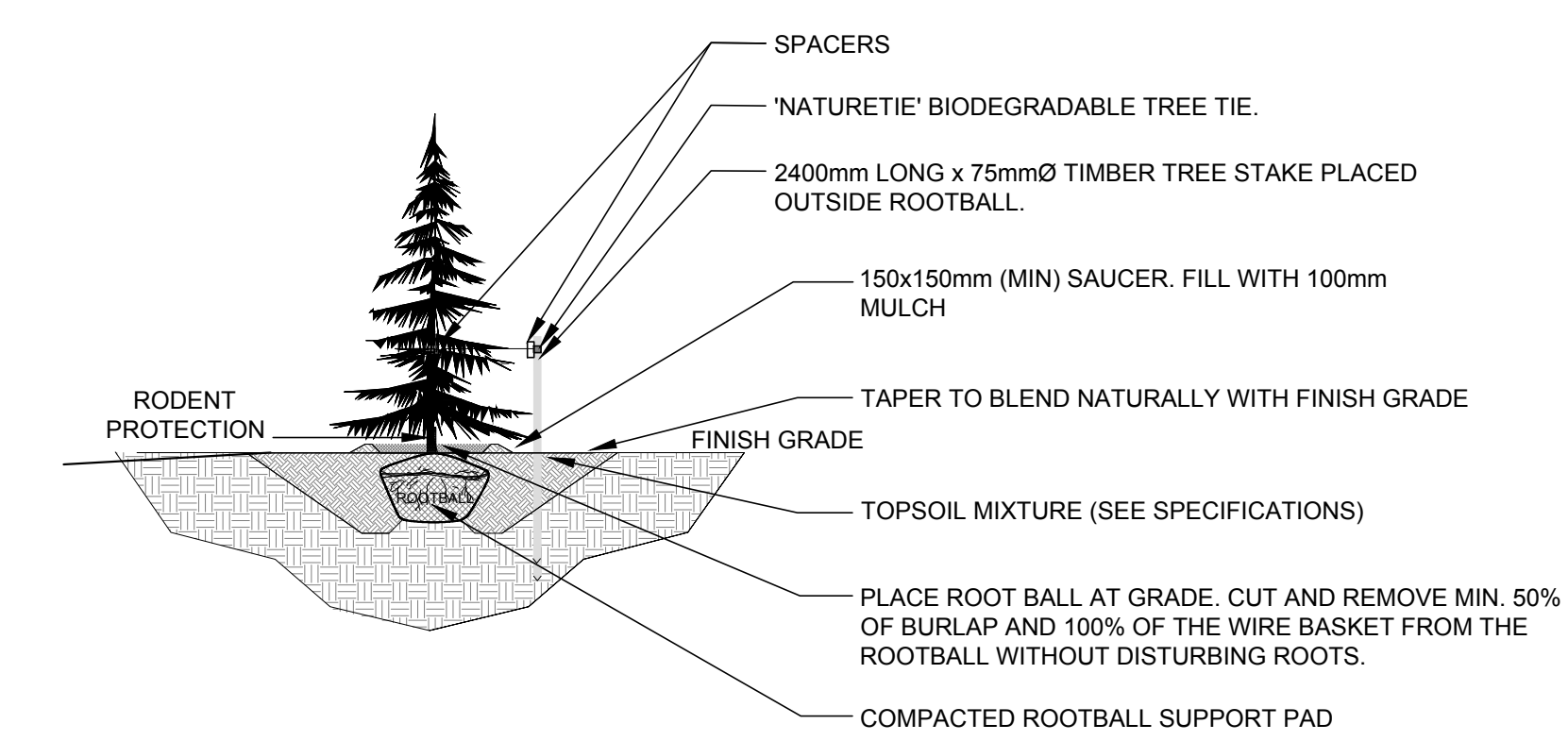

2	REVISED PER CIVIL COMMENTS	06/26/2024	ML	JL
1	ISSUED FOR DISCUSSION AND REVIEW	06/25/2024	ML	JL

No. Issue Date DR CK
MMEGOVY

JAMES B. LENNOX & ASSOCIATES INC.
LANDSCAPE ARCHITECTS
3332 CARLING AVE. OTTAWA, ONTARIO K2H 5A8
Tel: (613) 722-5168 Fax: (866) 343-3942

PROJECT
355 FRANKTOWN DEVELOPMENT
355 FRANKTOWN RD, CARLETON PLACE ON

DRAWING
TREE PLANTING PLAN

STAMP	SCALE
	AS SHOWN
	START DATE
	SEPTEMBER 2021
PROJECT NO.	23MIS2350

PROJECT NORTH

DRAWING NO.
L.1
PLOT SIZE ARCH-D