

SCHEDULE OF LAND USE		
LAND USE	LOT/BLOCK	AREA (sq.m/acs.)
DETACHED HOMES	BLOCKS 1-16, INCLUSIVE, AND 25	72326.5/17.87
STREETS	STREETS A TO STREET H	57605.9/14.23
SWM	BLOCK 19	23535.2/5.82
PUMP STATION	BLOCK 21	500.0/1.12
PARK/OPEN SPACE	BLOCK 20 AND 22	16266.9/4.02
MULTIUSE PATH	BLOCKS 23, 24 AND 26	15033.4/4.40
TOTAL		171837.5/42.46

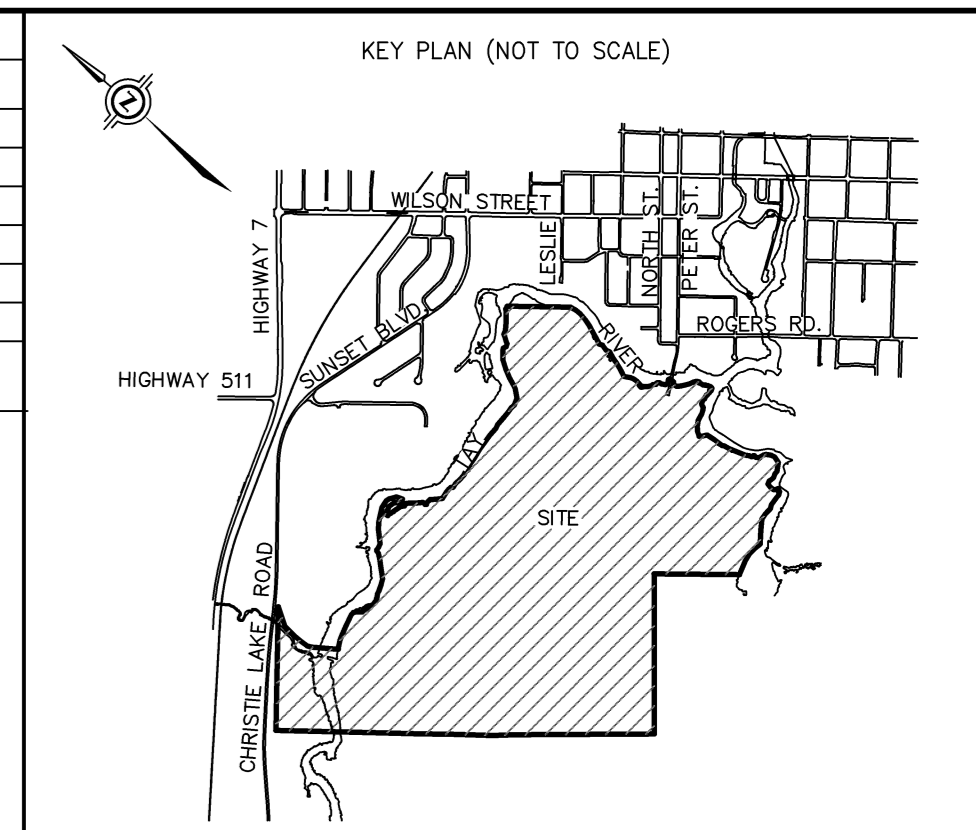

ADDITIONAL INFORMATION REQUIRED UNDER SECTION 51 OF THE PLANNING ACT.

(A)-(B)(C)(F)(G) AND (J)-(K) AS SHOWN ON DRAFT PLAN
 (C) AS SHOWN ON DRAFT AND KEY PLANS
 (D) LAND TO BE USED IN ACCORDANCE WITH SCHEDULE OF LAND USE
 (H) FULL MUNICIPAL SERVICES
 (I) OFFSHORE MARINE DEPOSITS OF CLAY, SILTY CLAY AND SILT, BEDROCK

DRAFT PLAN OF SUBDIVISION OF
**PART OF LOT 26 AND 27
 CONCESSION 1**
 AND
**PART OF LOT 25 AND 26
 CONCESSION 2**
 AND
**PART OF PARK LOTS 1, 2 AND 3
 IN LOT 27
 CONCESSION 2**
 AND
**PART OF LOT 26 AND 27
 CONCESSION 1**
 AND
**PART OF THE ROAD ALLOWANCE
 BETWEEN CONCESSIONS 1 & 2**
 ALL IN THE GEOGRAPHIC TOWNSHIP OF BATHURST
 AND
**PART OF LOT 1 IN SOUTHEAST
 HALF LOT 1, CONCESSION 1
 COMPILED PLAN No. 8828**
 AND
**PART OF LOT 1 IN SOUTHWEST
 HALF LOT 1, CONCESSION 2
 COMPILED PLAN No. 8828**
 ALL IN THE GEOGRAPHIC TOWNSHIP OF DRUMMOND
 TOWN OF PERTH
 AND
**PART OF THE ROAD ALLOWANCE
 BETWEEN GEOGRAPHIC TOWNSHIPS
 OF BATHURST AND DRUMMOND**

COUNTY OF LANARK
 J.D. BARNES LIMITED

METRIC DISTANCES AND/OR COORDINATES SHOWN ON THIS PLAN ARE IN METRES AND CAN BE CONVERTED TO FEET BY DIVIDING BY 0.3048.

SCALE 1:2000

NOTES

BEARINGS ARE UTM GRID, DERIVED FROM SPECIFIED CONTROL POINTS (SOP) 0307201501 AND 0101860227, UTM ZONE 18, NAD83 (CSRS).

ELEVATIONS

ELEVATIONS SHOWN ON THIS PLAN ARE RELATED TO GEODETIC DATUM CGD2011.

CONTOUR INTERVALS ARE SHOWN AS 1m FOR MAJOR AND 0.5m FOR MINOR.

--- DENOTES MAJOR CONTOUR
 - - - DENOTES MINOR CONTOUR

OWNER'S CERTIFICATE

CAVAN (PERTH) INC., BEING THE REGISTERED OWNER OF THE SUBJECT LANDS HEREBY AUTHORIZES J.D. BARNES LIMITED TO PREPARE AND SUBMIT THIS DRAFT PLAN OF SUBDIVISION FOR APPROVAL.

DATE _____ FRANK CARO
 PRESIDENT
 (I HAVE THE AUTHORITY TO BIND THE CORPORATION)
CAVAN (PERTH) INC.

SURVEYOR'S CERTIFICATE

I HEREBY CERTIFY THAT THE BOUNDARIES OF THE LAND TO BE SUBDIVIDED ARE CORRECTLY SHOWN.

DATE _____ G.M. FOX
 ONTARIO LAND SURVEYOR

J.D. BARNES SURVEYING & MAPPING LIMITED GIS
 LAND INFORMATION SPECIALISTS
 42 STANICE DRIVE, SUITE 103, KANAWA, ONTARIO
 T: (613) 731-7244 F: (613) 254-8659 www.jdbarnes.com

DRAWN BY: CE CHECKED BY: CF REFERENCE NO: 22-10-006-00 V5
 PLOTTED: 6/6/2022 DATE: 03/29/22

