

Phases	Single Lots								Semi-Detached Lots			Townhouse Lots			Total Units		Road Length		Saleable Frontage	
	43' Lots		60' Lots		Subtotal		Target Mix	Semi-Detached		Target Mix	Townhouses		Target Mix	Units	%	m	ft	m	ft	
	Units	%	Units	%	Units	%	%	Units	%	%	Units	%	%							
PHASE 7																				
Sub-Total	25	27%	0	0%	25	27%	20%	18	20%	20%	48	53%	60%	91	100%	623.5	2046	857.4	2813	
PHASE 8																				
Sub-Total	22	65%	0	0%	22	65%	20%	0	0%	20%	12	35%	60%	34	100%	227.7	747	412.0	1352	
Total	47	38%	0	0%	47	38%	20%	18	14%	20%	60	48%	60%	125	100%	851.2	2793	1269.4	4165	

Dwelling Type	Phase 7			Phase 8			Overall Site		
	# Units	Area (ha)	Net Density (units/ha)	# Units	Area (ha)	Net Density (units/ha)	# Units	Area (ha)	Net Density (units/ha)
PHASE 7 & 8									
Detached	25	1.07	23	22	1.17	19	47	2.24	21
Semi-Detached	18	0.53	34	0	0	0	18	0.53	34
Townhouse	48	1.10	44	12	0.40	30	60	1.49	40
Total	91	2.69	34	34	1.57	22	125	4.26	29

Phases	# Units	% Mix	Overall Site		
			OP Target Mix	Net Density (units/ha)	OP Target (units/net ha)
PHASE 7 & 8					
Low Density	65	52%	60%	23	15 - 30
Medium Density	60	48%	40%	40	30 - 40
High Density	-	-	-	-	-

Low Density = Single Lots + Semi-Detached Lots
Medium Density = Townhouse Lots

- LEGEND:**
- 43' WIDE MODELS
 - SEMI DETACHED
 - FREEHOLD 2-STORY TOWNHOUSES
 - FREEHOLD BUNGALOW TOWNHOUSES
 - STORMWATER MANAGEMENT POND / PARK
 - WALKWAY / SERVICING BLOCK
 - PARK LANDS
 - NATURALIZED BUFFER

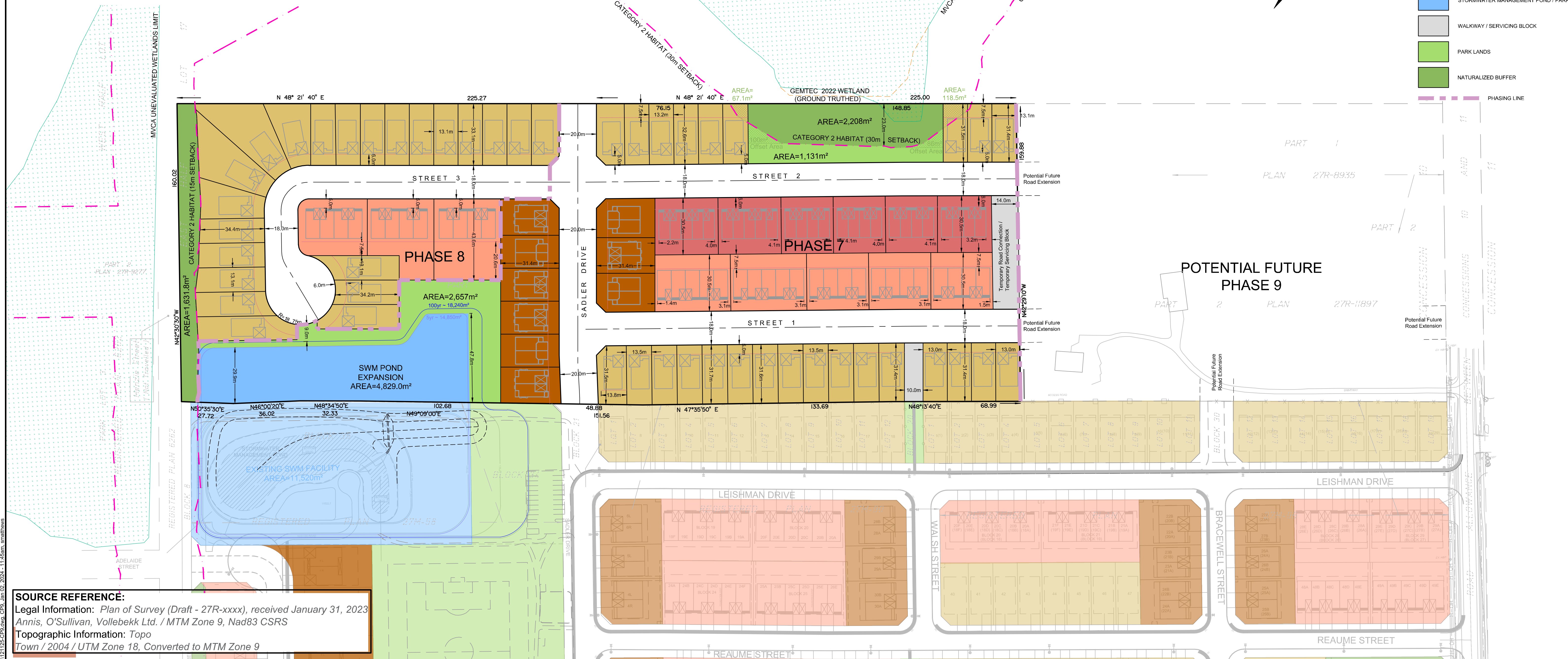
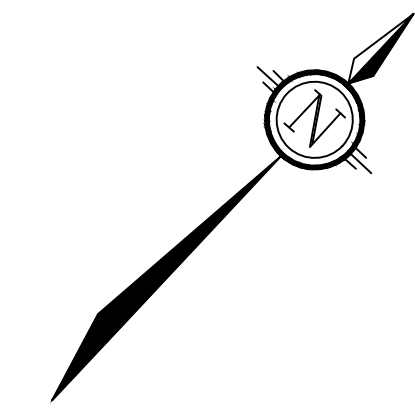

SOURCE REFERENCE:
Legal Information: Plan of Survey (Draft - 27R-xxxx), received January 31, 2023
Annis, O'Sullivan, Vollebek Ltd. / MTM Zone 9, Nad83 CSRS
Topographic Information: Topo
Town / 2004 / UTM Zone 18, Converted to MTM Zone 9

Net Density means the total number of dwelling units divided by the area of land (project area) in exclusively residential use, including lands and parking area internal to development and private amenity area, but excluding public streets, parks and open space, infrastructure and all non-residential uses.

No.	REVISION	DATE	BY
6	UPDATED PHASING LIMITS	JAN 2/24	DDB
5	REVISED SADLER DRIVE ALIGNMENT	SEPT 14/23	DDB
4	REVISED TOWNHOUSE SIDEYARD SPACING	AUG 29/23	DDB
3	REVISED PHASE 8 TOWNS / UPDATED LEGAL LINWORK	FEB 2/23	DDB
2	ISSUED FOR DRAFT PLAN APPLICATION	JAN 11/23	DDB
1	ISSUED FOR CLIENT REVIEW	NOV 30/22	DDB

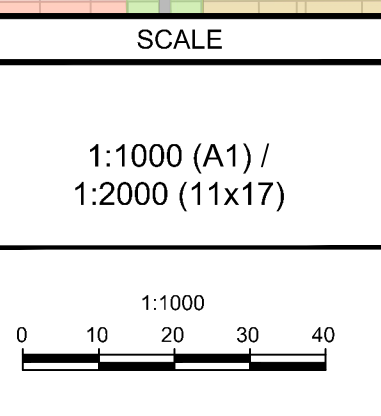

DESIGN	DDB
CHECKED	MER
DRAWN	SM
CHECKED	MER
APPROVED	DDB

NOVATECH
Engineers, Planners & Landscape Architects
Suite 200, 240 Michael Cowpland Drive
Ottawa, Ontario, Canada K2M 1P6
Telephone (613) 254-9643
Facsimile (613) 254-5867
Website www.novatech-eng.com

MISSISSIPPI MILLS
MILL RUN EXTENSION - PHASES 7 and 8

DRAWING NAME
CONCEPT PLAN 9

PROJECT No. 121125-00
REV 121125-CP9
REV # 8
DRAWING No. 121125-CP9

M:\2024\121125\CP9\Concept Plan\121125-CP9.dwg, CP9, Jun 02, 2024, 11:45am, tomahawks